

ZOOMLION

# FB30-35E

## ELECTRIC FORKLIFT

## Electric Forklift



### High-Strength Overhead Guard.

The overhead guard is made from special-shaped steel pipes, offering high strength and good sealing performance for the cabin.



### Full Vehicle LED Lighting.

The entire vehicle uses LED lighting, which is energy-efficient and significantly improves the performance and lifespan of the lights. The vehicle is made from environmentally friendly materials, reducing its impact on the environment.

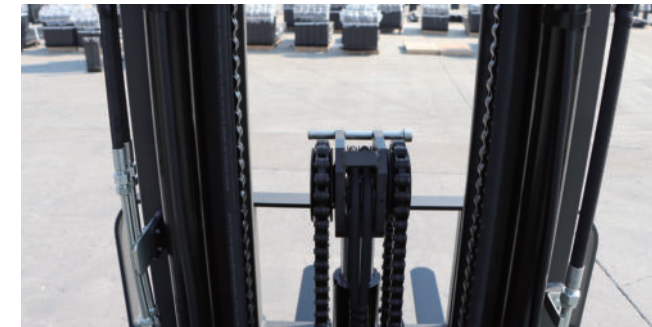

### Wide-Field View Overhead Guard

The newly designed overhead guard system features a lowered dashboard in the driver's cabin, greatly improving the driver's forward visibility.



### Optimized Large Access Handle

The optimized design of the large access handle makes boarding the vehicle more convenient.



### CHARGING PORT

### Charging Port Design

The side-mounted charging design eliminates the need to open the engine cover, making the charging process quicker and more convenient.

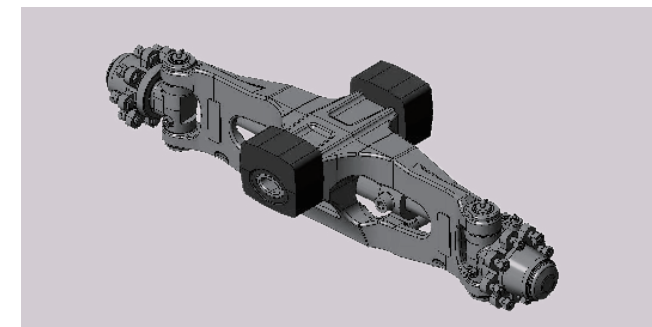

### Steering Bridge

The fully cast steering bridge offers longer service life and comes equipped with a shock absorption system, greatly enhancing the driver's comfort.

## Machine Parameters

Features	Model	/	FB30E	FB35E
	Drive Type: Electric (Battery), Diesel, Gasoline, Gas	/	Electric	Electric
	Driving Mode: (Manual, Walk-behind, Stand-on, Sit-down, Picking)	/	Sit-down	Sit-down
	Rated Load	Q(kg)	3000	3500
	Load Center Distance	c(mm)	500	500
	Front Overhang Distance	x(mm)	490	490
Weight	Wheelbase	Y(mm)	1710	1710
	Weight (including battery)	kg	4530	4830
Tires & Chassis	Axle Loads when unloaded Front /Rear	kg	1880/2650	1995/2835
	Wheels (Rubber, High-Elasticity, Pneumatic, Polyurethane)	/	Pneumatic/solid tires	Pneumatic/solid tires
	Front Tire	/	28*9-15	28*9-15
	Rear Tire	/	200/50-10	200/50-10
	Wheel Count (x = Driven Wheels)	/	2x / 2	2x / 2
	Front Wheel Track	b10(mm)	1005	1005
Dimensions	Rear Wheel Track	b11(mm)	970	970
	Mast / Fork – Forward / Back Tilt Angle	$\alpha/\beta(^{\circ})$	6/10	6/10
	Height with Mast Retracted	h1(mm)	2090	2090
	Free Lift Height	h2(mm)	150	150
	Lift Height	h3(mm)	3000	3000
	Max Working Height with Mast	h4(mm)	4290	4290
	Overhead Guard Height	h6(mm)	2180	2180
	Traction pin height	h10(mm)	330	330
	Overall Length	l1(mm)	3625	3625
	Vehicle length	l2(mm)	2555	2555
	Overall Width	b1(mm)	1220	1220
	Fork Dimensions	s/e/l(mm)	50/125/1070	50/125/1070
	Fork Frame Width	b5(mm)	1100	1100
	Ground Clearance at Wheelbase Center	m2(mm)	150	150
	Aisle Width for 1000x1200 Pallet (1200 across Forks)	Ast(mm)	4000	4000
	Aisle Width for 800x1200 Pallet (1200 along Forks)	Ast(mm)	4200	4200
	Turning Radius	Wa(mm)	2300	2300
Performance Data	Travel Speed, Full Load / Unloaded	Km/h	17/19	17/19
	Lift Speed, Full Load / Unloaded	m/s	380/450	350/450
	Lowering Speed, Full Load / Unloaded	m/s	380/230	380/230
	Max Climbing Ability, Full Load / Unloaded	%	15/15	15/15
Motor	Braking	/	Hydraulic	Hydraulic
	Drive motor power S2 60 min	kW	16.6	16.6
	Lift Motor Power S3 15%	kW	25	25
	Battery type	/	Li-ion	Li-ion
	Battery Voltage / Rated Capacity	V/Ah	80/280	80/280
Other	Battery Weight	kg	230	530
	Drive Control Type	/	AC	AC
	Noise Level Near Driver's Ear	dB	75	75

## ELECTRIC FORKLIFT

**FB30E/FB35E** Series Lithium Battery Electric Truck is a product developed by Zoomlion based on a deep understanding of electric and internal combustion forklifts. It breaks traditional design concepts by introducing a unique structure and using a new energy vehicle voltage platform. The series represents a significant leap in efficiency, power, and reliability, surpassing internal combustion forklifts and redefining the next generation of electric forklifts.

### Capacity Chart

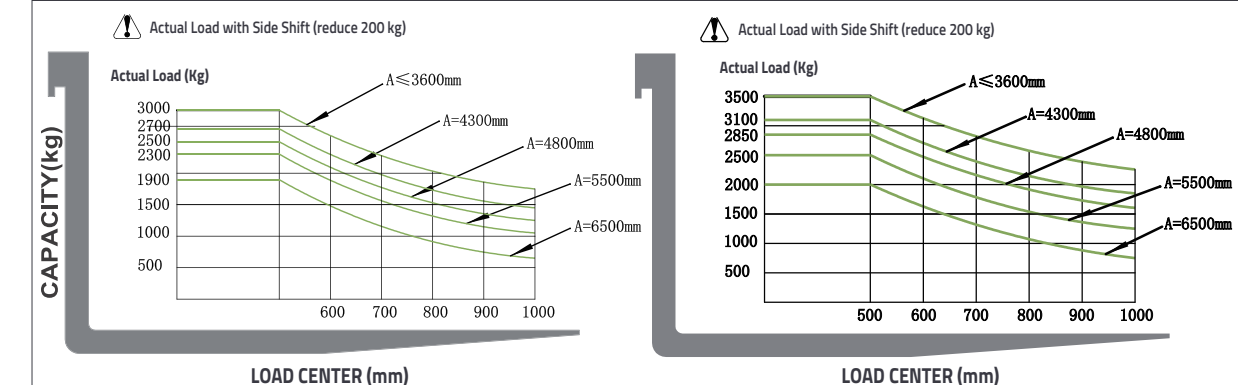

### Machine 2D Graph

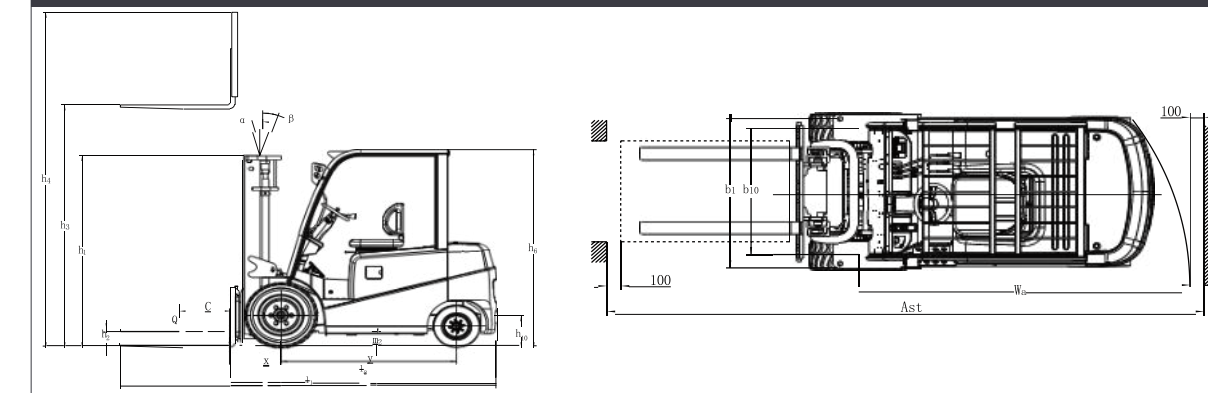

### Advantages

Stylish appearance with strong and smooth lines, compact and exquisite design, offering a modern yet stable look.

Long-lasting endurance with a large-capacity lithium battery as standard. Fast charging with a super-fast charging technology as standard.

Safe and reliable with a fully enclosed design and high protection level, making it suitable for harsh working environments. Convenient maintenance, with a lockable engine cover and easy access for fluid refills and routine maintenance.